

AERIAL VIEW

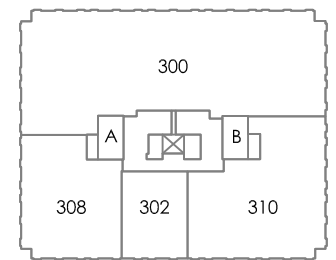

EXTERIOR ELEVATION



KEY PLAN

COURTHOOD CRESCENT

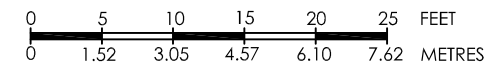

PREPARED BY: ECHOFLOORPLANS.COM



ECHO FLOOR PLANS
 ■ As-Built Floor Plans
 ■ Area Analysis
 ■ Space Planning
 www.ECHOFloorPlans.com

PREPARED FOR: Nitro IT Business Solutions
ADDRESS: 1750 Courtwood Crescent,
 Ottawa, ON
DATE: April 7, 2011
REVISION: n/a
PROJECT NUMBER: 100232
DRAWING SIZE: 8.5" x 14" - Legal Size